

**STAGE 1**

SCALE: 1" = 20'-0"

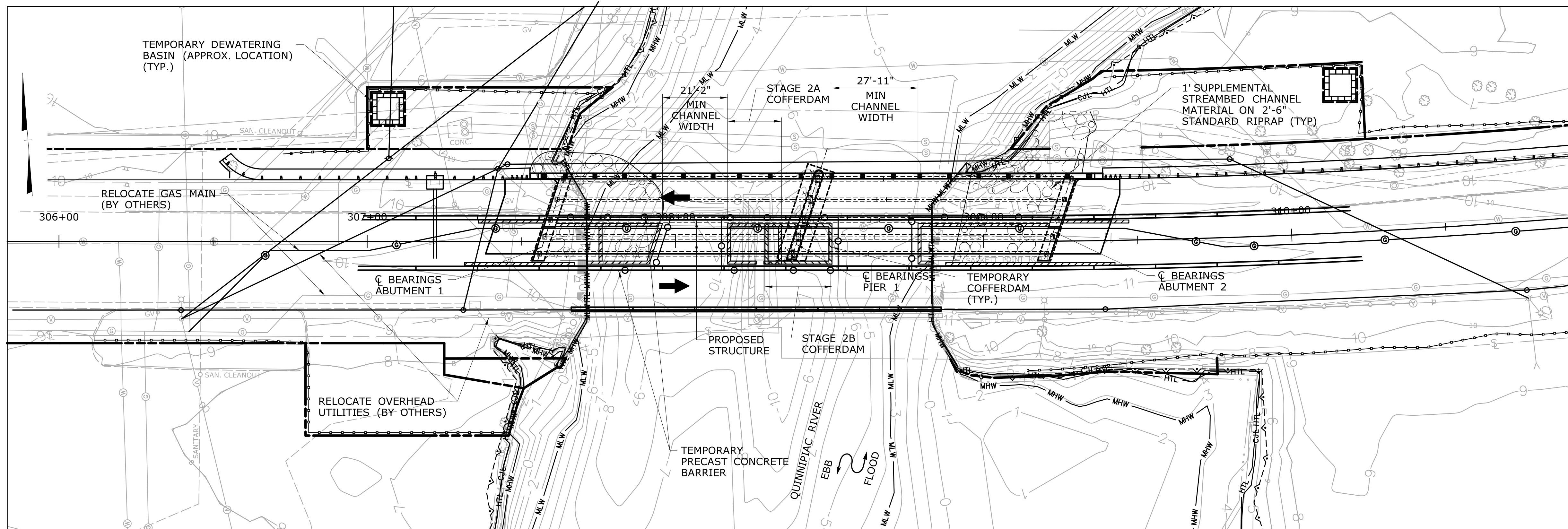

**STAGE 2**

SCALE: 1" = 20'-0"

TEMPORARY HYDRAULIC DATA	
MEAN LOW WATER	-3.4 FT
MEAN HIGH WATER	2.9 FT
HIGH TIDE LINE (1-YEAR TIDE)	4.5 FT
TEMPORARY DESIGN FREQUENCY	TIDAL: 1-YEAR RIVERINE: 5-YEAR
TEMPORARY DESIGN DISCHARGE	3,584 CFS
TEMPORARY DESIGN ELEVATION	5.4 FT

**LEGEND**

- TIDAL WETLANDS
- COASTAL JURISDICTION LINE (ELEVATION 4.60 FEET)
- HIGH TIDE LINE (ELEVATION 4.47 FEET)
- MEAN HIGH WATER LINE (ELEVATION 2.85 FEET)
- MEAN LOW WATER LINE (ELEVATION -3.35 FEET)
- SEDIMENTATION CONTROL SYSTEM
- TURBIDITY CURTAIN

**GENERAL NOTES:**

1. VERTICAL CONTROL IS BASED UPON THE NORTH AMERICAN VERTICAL DATUM OF 1988 (NAVD 88).

**WATER HANDLING NOTES:**

1. THE CONTRACTOR SHALL MAINTAIN WATER THROUGH THE EXISTING CHANNEL AS SHOWN DURING CONSTRUCTION OF THE NEW STRUCTURE.
2. A TEMPORARY DEWATERING BASIN SHALL BE ESTABLISHED. THE LOCATION OF THE DEWATERING BASIN IS APPROXIMATE. THE EXACT LOCATION MAY VARY BASED ON THE PUMPING DESIGN SUBMISSION AND APPROVAL BY THE ENGINEER.
3. THE TEMPORARY COFFERDAM SHALL BE INSTALLED INTO THE BED OF THE RIVER. IT SHALL NOT INFRINGE ON MINIMUM CHANNEL WIDTHS, SHALL BE ABLE TO SUPPORT CONSTRUCTION ACTIVITY AND EXCAVATION, AND SHALL CONFORM TO PERMITS.  
  
MAXIMUM TOP OF COFFERDAM ELEVATION = 5.6 FEET
4. BARGE LOCATIONS AND SIZES TO BE DETERMINED BY CONTRACTOR. THE MAXIMUM SIZE OF EACH BARGE IS ANTICIPATED TO BE APPROXIMATELY 30 FEET X 40 FEET. BARGES ARE TO BE SECURED TO THE RIVER WITH SPUD ANCHORS.
5. CRANE OUTRIGGER PADS SHALL NOT ENCRANCH UPON THE UPLAND-MOST OF THE TIDAL WETLANDS OR COASTAL JURISDICTION BOUNDARIES.

**REFERENCES**

1. SEE DWG. NO. S-04 FOR BRIDGE STAGING SECTIONS.
2. SEE DWG. NO. S-10 FOR DEMOLITION PLAN.
3. SEE DWG. NO. S-11 FOR SUGGESTED SEQUENCE OF CONSTRUCTION.

REV.	DATE	REVISION DESCRIPTION	SHEET NO.
-	-	-	-
-	-	-	-
-	-	-	-
-	-	-	-
-	-	-	-
-	-	-	-

THE INFORMATION, INCLUDING ESTIMATED QUANTITIES OF WORK, SHOWN ON THESE SHEETS IS BASED ON LIMITED INVESTIGATIONS BY THE STATE AND IS IN NO WAY WARRANTED TO INDICATE THE CONDITIONS OF ACTUAL QUANTITIES OF WORK WHICH WILL BE REQUIRED.

DESIGNER/DRAFTER:  
**W. WOLFE/C. SCATENA**  
CHECKED BY:  
**M. SHAW**  
SCALE AS NOTED

**TOWN OF NORTH HAVEN**  
DEPARTMENT OF ENGINEERING  
Filename: ...\\SB\_MSH\_Br03743\_0100\_0175\_WHP002.dgn

SIGNATURE/BLOCK:  
 **Dewberry**  
59 Elm Street, Suite 101  
New Haven, CT 06510-2047

PROJECT TITLE:  
**RECONSTRUCTION OF SACKETT POINT ROAD AND REPLACEMENT OF BRIDGE NO. 03743 OVER THE QUINNIPIAC RIVER**

TOWN:  
**NORTH HAVEN**  
DRAWING TITLE:  
**STAGING/WATER HANDLING PLAN - 2**

PROJECT NO.  
**100-175**  
DRAWING NO.  
**S-12**  
SHEET NO.  
**79**